

### Digital Kitchen Scale

models 00943 / 00944 / 00945



#### CONTENTS

Package Contents .....	2	Set the Measurement Units .....	4
Customer Support .....	2	Using the Scale .....	5
Features & Benefits .....	3	Troubleshooting .....	7
Setup .....	4	Care & Maintenance .....	7
Install or Replace Battery .....	4	Specifications .....	7

**Questions?** Contact Customer Support at  
(877) 221-1252 or visit [www.AcuRite.com](http://www.AcuRite.com).

**SAVE THIS MANUAL FOR FUTURE REFERENCE.**



Congratulations on your new AcuRite product. To ensure the best possible product performance, please read this manual in its entirety and retain it for future reference.

## Package Contents

1. Scale
2. Instruction Manual

## Customer Support

AcuRite customer support is committed to providing you with best-in-class service. **For assistance**, please have the model number of this product available and contact us in any of the following ways:



(877) 221-1252



info@chaney-inst.com

24/7 support at [www.AcuRite.com](http://www.AcuRite.com)

- ▶ Installation Videos
- ▶ Register your Product
- ▶ Instruction Manuals
- ▶ Support User Forum
- ▶ Replacement Parts
- ▶ Submit Feedback & Ideas

# Features & Benefits

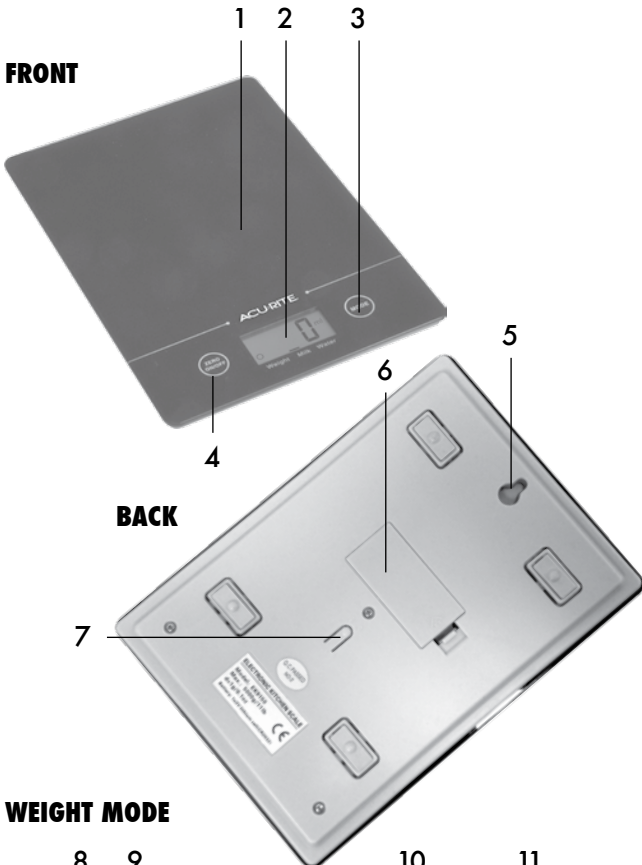

**FRONT**

## FRONT

- 1. Weighing Area
- 2. Display
- 3. **MODE** Button
- 4. **ZERO & ON/OFF** Button

**BACK**

## BACK

- 5. **Integrated Hang Hole**  
for wall mount storage.
- 6. **Battery Compartment**
- 7. **Unit Conversion Button**

## WEIGHT MODE

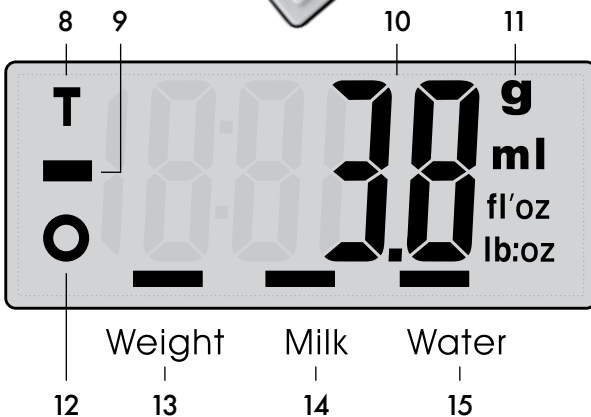

## WEIGHT MODE

- 8. **Tare Indicator**
- 9. **Minus Indicator**  
Indicates weight of item(s) removed from the scale.
- 10. **Current Weight**
- 11. **Weight Units**
- 12. **Zero Indicator**
- 13. **Weight Mode Indicator**
- 14. **Milk Mode Indicator**
- 15. **Water Mode Indicator**

## Install or Replace Battery

1. Remove the battery compartment cover.
2. Insert 1 x 3V CR2032 lithium battery into the battery compartment, as shown. Follow the polarity (+/-) diagram in the battery compartment.
3. Replace the battery cover.

### 1 Remove Battery Cover

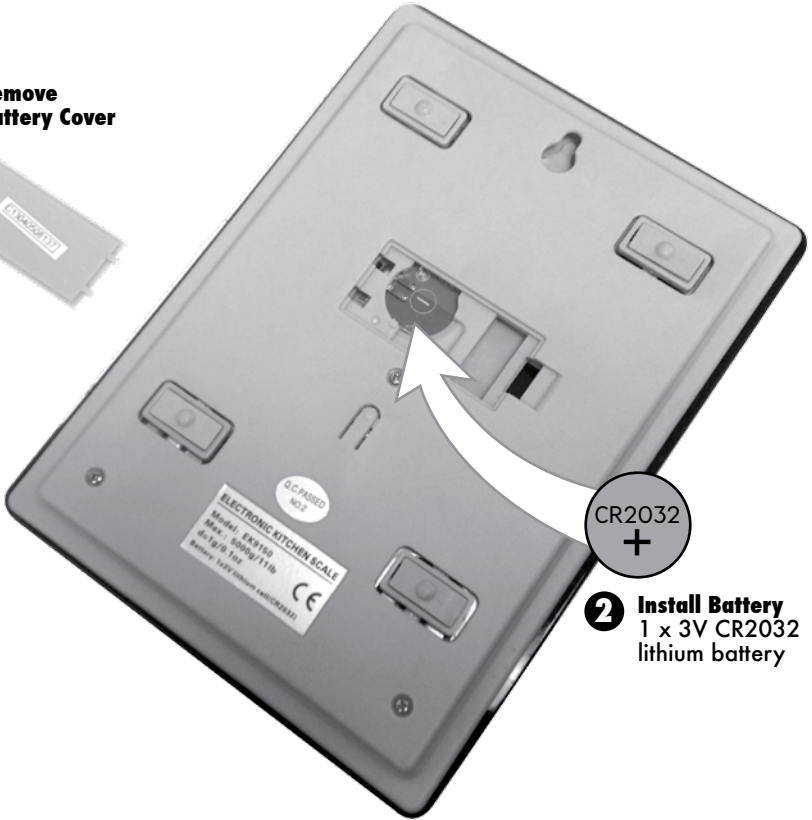

### 2 Install Battery 1 x 3V CR2032 lithium battery

## Set the Measurement Units

When you are in Weight Mode, press the Unit Conversion button, located on the back of the scale, to toggle between kg/g and lb/oz.



**WARNING: THIS PRODUCT CONTAINS A BUTTON-CELL BATTERY. IF SWALLOWED, IT COULD CAUSE SEVERE INJURY OR DEATH IN JUST 2 HOURS. SEEK MEDICAL ATTENTION IMMEDIATELY IF INGESTED.**



## Using the Scale

### Measure Weight

The scale's default mode is set to weigh solid items. Volume Mode, used for weighing liquids, allows you to choose between WATER or MILK modes because milk is denser than water.

#### Weight Mode

1. Place the scale on a flat, stable surface.
2. Press ZERO/ON/OFF button to turn scale on.
3. Wait for the display to show 0 weight.
4. Make sure scale is in Weight Mode. If not, use MODE button to select Weight Mode. (show MODE button and MODE indicators)
5. Place item(s) to be weighed onto the surface of the scale.
6. Weight will be shown on the display.

#### Volume Mode

1. Place the scale on a flat, stable surface.
2. Press ZERO/ON/OFF button to turn scale on.
3. Wait for the display to show 0 weight, then press the MODE button until MODE indicator is on for Milk or Water.
4. Place a container on the scale.
5. Press ZERO/ON/OFF button to reset display to 0.
6. Pour liquid into the container. Display will show liquid volume.
7. To view the weight of the liquid, press MODE button until Weight Mode indicator is on.

### Zero & Tare Functions

To measure items as they are added, use the Zero and Tare Functions. If the weight of the items being measured is below 4% of the scale's capacity (less than 0.2kg/0.4lb), the Zero function is used. If the weight of the items exceeds 4% of the scale's capacity, the Tare function is used.

1. Place the first item(s) within the center of the Weighing Area of the scale to take a measurement.
2. Without removing the item(s), press the ZERO/ON/OFF button to reset the display to 0.
3. Depending on the weight of the item(s), you will see the Zero indicator "O" or the Tare indicator "T" on the display.
4. With the first item(s) still in place, add the next item to the surface of the scale. The display will now show the weight of that item.

5. Press ZERO/MODE to see the combined weight of the two items.
6. Press ZERO/MODE again to reset the display to 0.
7. Repeat these steps until all items have been added.

Note: Adhere to the maximum weight capacity of the scale.

## Minus Function

If you add multiple items to the scale at one time to get a total weight, you can identify the value of a single item or ingredient by using the Minus Function:

1. Add item(s) to the scale; display shows total weight.
2. Press ZERO/ON/OFF to reset display to 0.
3. Remove an item.
4. Display shows the weight of the removed item with the Minus Function indicator (negative value is shown on the display).
5. Remove both items to see the combined weight of the two items.
6. Repeat steps as needed.

## Warning Messages



Replace battery (see page 4).



Maximum capacity has been exceeded. Remove items to prevent damage.

## Power the Unit ON/OFF

The scale will automatically power off when the display shows 0 or the same weight for 2 minutes. Press ZERO/ON/OFF to power the scale on. To power off manually, press ZERO/ON/OFF when the LCD is showing 0, or press and hold ZERO/ON/OFF for 3 seconds if a weight is shown on the display.

## Storage

The scale can be stored on a level surface or can be hung by using the integrated hang hole.

## Troubleshooting

Problem	Possible Solution
<b>Display screen not working</b>	<ul style="list-style-type: none"><li>• Check that the batteries are installed correctly. Batteries may need to be replaced.</li></ul>

**If your AcuRite product does not operate properly after trying the troubleshooting steps, visit [www.AcuRite.com](http://www.AcuRite.com) or call (877) 221-1252 for assistance.**

## Care & Maintenance

Store in a dry location at room temperature. Clean with a soft, damp cloth. DO NOT immerse in water or use caustic cleaners or abrasives. All parts should be wiped clean immediately after direct contact with foods. Avoid contact with acids and citrus juices. Use the scale on a hard, flat surface. DO NOT strike, shake or drop the scale. Scale is not designed for commercial use.

## Specifications

<b>MAX WEIGHT CAPACITY</b>	5kg / 11lbs
<b>POWER</b>	3V CR2032 lithium battery

# ACURITE®



Weather  
Stations



Temperature  
& Humidity



Weather  
Alert Radio



Kitchen  
Thermometers  
& Timers



Clocks

It's more than accurate, it's **ACURITE®**.

AcuRite offers an extensive assortment of precision instruments, designed to provide you with information you can depend on to Plan your day with confidence™.

[www.AcuRite.com](http://www.AcuRite.com)

©Chaney Instrument Co. All rights reserved. AcuRite is a registered trademark of the Chaney Instrument Co., Lake Geneva, WI 53147. All other trademarks and copyrights are the property of their respective owners. AcuRite uses patented technology. Visit [www.AcuRite.com/patents](http://www.AcuRite.com/patents) for details.